

BUTTERFLY CONTROL VALVES TYPE R1



GENERAL INDICATIONS

The butterfly control valves type R1 have been designed for the use with air or other fluids with temperature up to 280°C.

Thanks to its robust structure and to the self-lubricating support bushing of the shaft, the valves type R1 guarantee an high adjustment accuracy and the an high reliability during time even in critical working conditions.

The R1 valves can be coupled with electrical servomotors, linear pneumatic cylinders and rotating pneumatic actuators with double and single acting. The optional application of a metal sealing, reduces the blow-bys with closed valve at less than 1%.

TECHNICAL CHARACTERISTICS

- TYPE** : Wafer type for flanges mounting UNI-DIN PN6,10,16
ANSI B16.5 class 150
- ND** : From ND50 up to ND2000, other sizes on request
- BODY** : Carbon steel, cast iron, other materials on request
- BUTTERFLY** : Carbon steel, cast iron, other materials on request
- SHAFT** : Chromed carbon steel, other materials on request

DIMENSIONAL DRAWING

ND	A	B		C	D	E	F	J	W
		NP6	NP16						
50	50	92	104	50	20	95	130	80	225
65	65	112	124	50	20	105	130	90	235
80	80	128	140	50	20	115	130	100	245
100	100	148	160	50	20	130	130	110	260
125	125	178	190	50	20	140	130	120	270
150	150	202	215	50	20	160	130	140	290
175	175	232	242	50	20	175	130	150	305
200	200	257	268	50	20	190	130	165	320
225	225	282	320	50	20	210	130	190	350
300	300	368	378	50	20	260	130	215	390
350	335	418	438	60	25	290	130	240	420
400	385	468	490	60	25	325	130	270	455
450	430	522	550	60	25	345	130	295	475
500	480	572	610	60	25	375	130	320	505

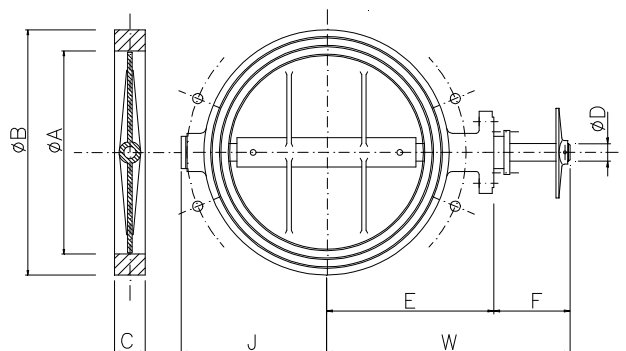

RA SYSTEM S.R.L.

SISTEMI DI REGOLAZIONE & AUTOMAZIONE

Via Adamello, 9 - 20010 BAREGGIO (MI) Italy
Tel. 0039-02-90362484 Fax 0039-02-90362485
web www.rasystem.com Email info@rasystem.com

SHAFT SEAL

- 1 Stuffing box shutter
- 2 Seal regulation stud bolt
- 3 Braid packet made of graphitized fiber glass yarn
- 4 Self-lubricating bushing

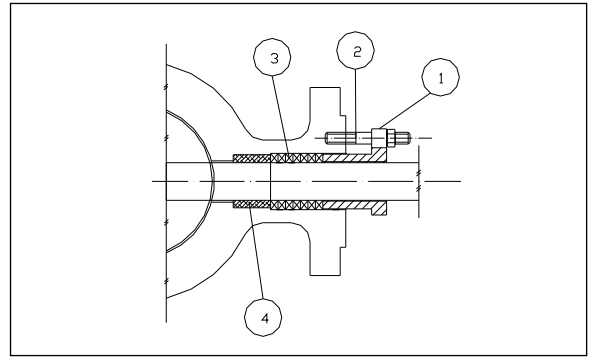

OPTIONAL METAL SEALING

- 1 Body
- 2 Metal sealing ring
- 3 Butterfly

The optional application of a metal sealing, reduces the blow-bys with closed valve at less than 1%.

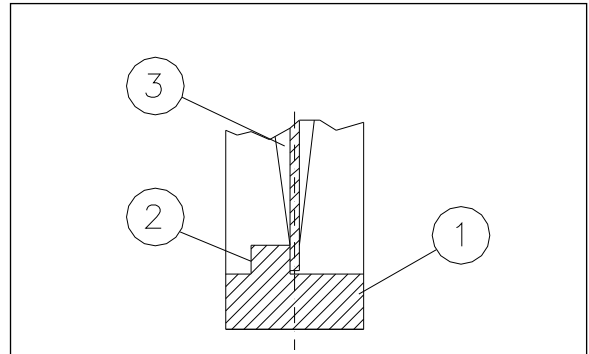

VALVE TYPE R1 WITH 4501 ELECTRICAL SERVOMOTOR

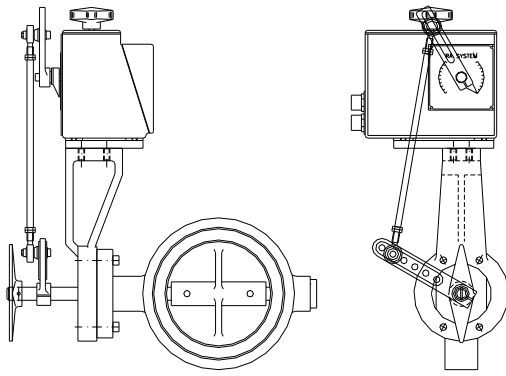

VALVE TYPE R1 WITH 4521 ELECTRICAL SERVOMOTOR

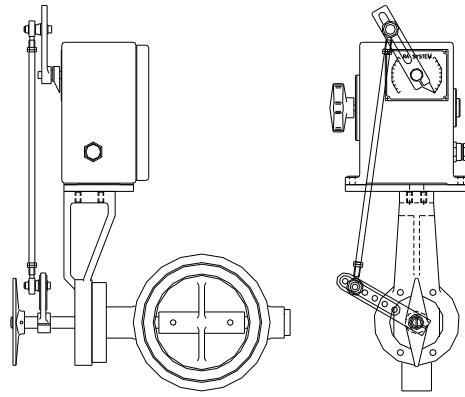

VALVE TYPE R1 WITH LINEAR PNEUMATIC ACTUATOR

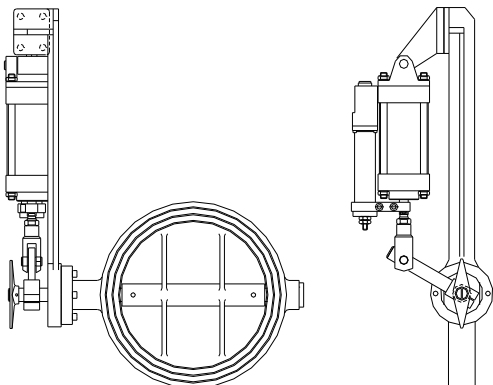

VALVE TYPE R1 WITH ROTATING PNEUMATIC ACTUATOR

